

# RAICH02

KANEKA  
MEDICAL  
PRODUCTS

## HEMOSTASIS FORCEPS

- Thin sheath (2.3mm)
- 1:1 Rotation
- High torque transmissive wire



### Thin sheath

- Allows easier insertion in case of full-angulation
- Improves suction power and increases suction volume during procedure
- Helps easy suction securing practitioners' field of vision

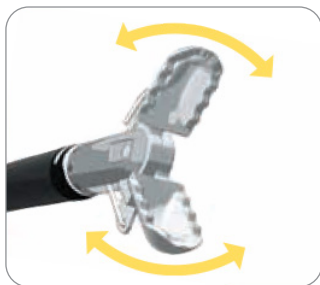
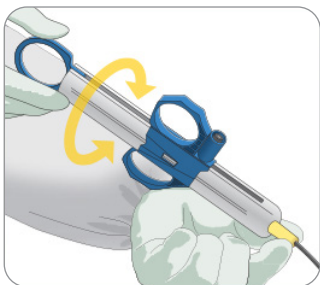
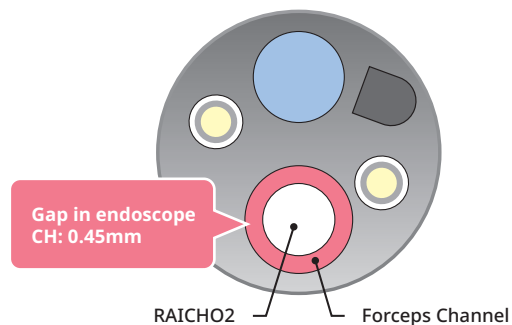

### 1:1 Rotation

Captures the bleeding point accurately at various angles

### High torque transmissive

Easy to rotate cup portion

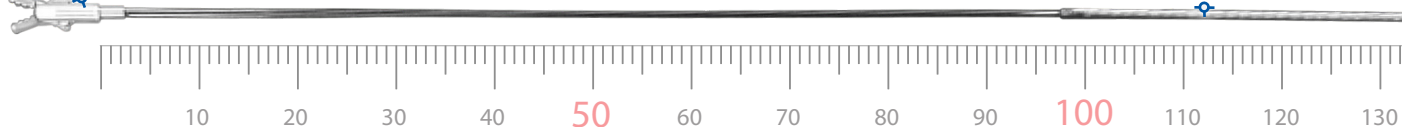

### Ordering Information

Product Code	Sheath Length	Opening Width	Sheath Diameter	Working Channel
RC1550-2WE	1,550mm	6mm	2.3mm	2.8mm
RC1900-2WE	1,900mm	6mm	2.3mm	2.8mm
RC2200-2WE	2,200mm	6mm	2.3mm	2.8mm
RC2200-2SC	2,200mm	4mm	2.3mm	2.8mm